



Wheeled Excavator Family

HW-A series – HW100A, HW140A, HW160A, HW170A CR, HW210A
Compact Wheeled – R55W-9A



* Photo may include optional equipment.

building a **comfortable** tomorrow

YOUR EDGE FOR SPEED AND VERSATILITY

The Hyundai wheeled excavator product line includes five HW-A series models and one 9A series compact model to give you an edge in a wide range of on-road and off-road applications. These Tier 4-Final-compliant wheeled excavators deliver improved performance, increased fuel efficiency, superior travel speeds on the road, an enhanced cab and added safety features.



HW100A

NET POWER

100 HP (75 kW) at 2,000 rpm

OPERATING WEIGHT

23,589 lbs (10,700 kg)

Maximum Dig Depth

13' 11" (4,245 mm)

Travel Speed

23.2 mph (37.4 km/h)

Bucket Breakout Force (ISO)

13,175 lbf (5,976 kgf)



HW140A

NET POWER

170 HP (127 kW) at 2,200 rpm

OPERATING WEIGHT

34,762 lbs (15,768 kg)

Maximum Dig Depth

16' 9" (5,110 mm)

Travel Speed

24.9 mph (40 km/h)

Bucket Breakout Force (ISO)

23,135 lbf (10,494 kgf)



HW160A

NET POWER

170 HP (127 kW) at 2,200 rpm

OPERATING WEIGHT

40,060 lbs (18,171 kg)

Maximum Dig Depth

18' 10" (5,760 mm)

Travel Speed

21.7 mph (35 km/h)

Bucket Breakout Force (ISO)

25,895 lbf (11,746 kgf)



* Specs refer to standard equipment. Pictured model may reflect optional items.

HW-A Series – HW100A, HW140A, HW160A, HW170A CR, HW210A

Scan QR codes to download spec sheets for each model



HW170A CR

NET POWER

170 HP (127 kW) at 2,200 rpm

Travel Speed

21.7 mph (35 km/h)

OPERATING WEIGHT

42,185 lbs (19,135 kg)

Bucket Breakout Force (ISO)

25,895 lbf (11,746 kgf)

Maximum Dig Depth

18' 3" (5,566 mm)



HW210A

NET POWER

170 HP (127 kW) at 2,200 rpm

Travel Speed

23.9 mph (38.4 km/h)

OPERATING WEIGHT

46,685 lbs (21,176 kg)

Bucket Breakout Force (ISO)

33,951 lbf (15,400 kgf)

Maximum Dig Depth

21' 1" (6,430 mm)



R55W-9A

NET POWER

66.9 HP (49.9 kW) at 2,400 rpm

Travel Speed

18.6 mph (30 km/h)

OPERATING WEIGHT

26,985 lbs (12,240 kg)

Bucket Breakout Force (ISO)

9,546 lbf (4,330 kgf)

Maximum Dig Depth

11' 6" (3,500 mm)

Please see page 11 for product detail.



PROVEN PERFORMERS

Hyundai wheeled excavators are known for fast cycle times, impressive hydraulic power and precision control. Adding to that success formula, the Hyundai HW-A series features eco-friendly, high-performance engines that meet the Tier 4 Final emission requirements. Others promise performance; Hyundai delivers.

Faster
cycle
speeds

(As compared to
previous 9A series)



* Photo may include optional equipment.

Swing-lock System Option

The optional swing-lock system maintains stability when the swing movement needs to be limited, improving operating speed and productivity.

Fine Swing Control Option

The optional fine swing control provides additional precision through reduced swing shock under load at slow swing speeds.

Boom Float Mode Option

This new option improves stability and control when leveling, allowing the boom to float along as the arm is moved in and out.

New Variable Power Control

The HW-A series features variable power control with three power modes to ensure the highest performance in any operating environment.

- P (power) mode: Maximizes speed and power for heavy work.
- S (standard) mode: Optimizes performance and fuel efficiency for general work.
- E (economy) mode: Improves control and efficiency for light work.

Electronic Viscous Fan Clutch

The electronic fan clutch reduces noise, and minimizes fuel consumption during operation by precisely controlling RPM depending on the hydraulic oil and coolant temperature. During cold applications the fan slows to allow hydraulic oil to warm up to optimal operating temperature.

ECO Gauge

Using this function, the operator can monitor fuel consumption in real time or review historical data. The colored gauge represents engine torque and fuel efficiency. Also displayed are the average and total fuel consumed. The hourly and daily fuel consumption is also viewable through the menu.



IPC (Intelligent Power Control)

This mode analyzes operator control patterns, and automatically adjusts engine RPM and hydraulic flow to ensure maximum fuel economy and productivity.

Robust Cooler Door with Vented Grille

The cooler door grille is designed for maximum air flow and reduced contamination.



Attachment Flow Control

The HW-A series improves pump flow rate by giving the operator independent control of two pumps. It optimizes flow rate settings according to the attachment type (10 breaker types and 10 crusher types), which is ideal for various applications.

New Cooling System with Increased Air Flow

The HW-A series has a vertically stacked cooling configuration which provides improved cooling efficiency through increased air flow and reduced heat.



* Features and options shown on this spread apply to the HW-A series.



RELIABLE PRODUCTIVITY

► Heavy-duty Cooling Module

Each HW-A series excavator has a heavy-duty cooling module designed to provide maximum engine protection in the harshest working environments.

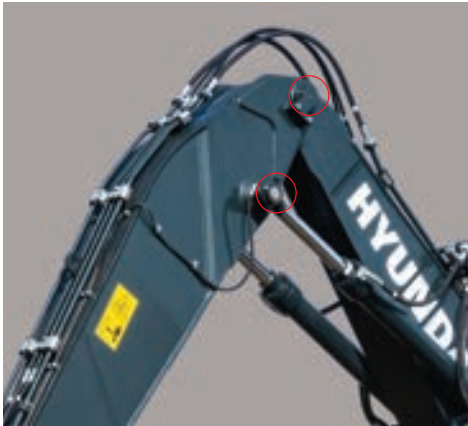
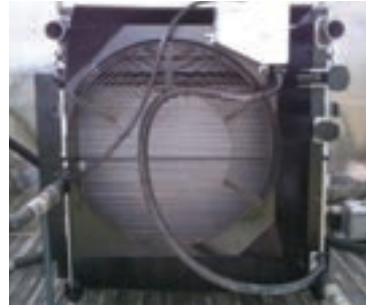

► Reinforced Pins, Bushings and Polymer Shims

The HW-A series improved boom-and-attachment design — utilizing wear-resistant long-life pins, bushings and polymer shims — enhances attachment reliability and durability.

► Wear-resistant Cover Plate

A wear-resistant cover plate at the end of the arm minimizes abrasion on the pin connection between the arm and the bucket. This reduces bucket vibrations for improved operator control, even under heavy load conditions.



► Reinforced Upper and Lower Structure and Attachments

Hyundai's new buckets are reinforced with wear-resistant Hardox 400 steel for additional durability.

► High-grade, High-pressure Hoses

The HW-A series uses high-grade, high-pressure hoses with increased heat- and pressure-resistance for improved durability.

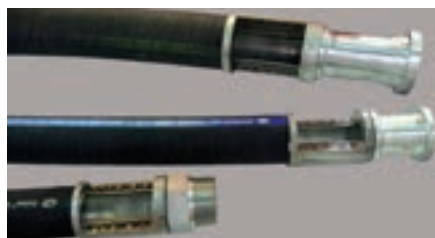

► Convenient Cab Air Filter Access

Lockable door located on the outside of the cab for easy exchange of the cab air filter.

Rugged for Today, Durable for Years

At Hyundai, reliable productivity is no empty promise. Performance on the HW-A series wheeled excavators is proven. The robust upper and lower frame structure can endure external shock and heavy workloads for many thousands of hours. Starting with our strict, demanding prototype testing procedures, Hyundai tests new designs in harsh environments with actual operators for 10,000 hours prior to bringing a new model to market. No matter how tough the working environment is, you can always rely on the Hyundai HW-A series.



* Features and options shown on this spread apply to the HW-A series.

* Photo may include optional equipment.



New Air Conditioning System

The operator's cab in each HW-A series wheeled excavator features an enhanced-capacity air conditioning and heating system. The auxiliary heat capacity is increased by 15 percent, providing a consistently comfortable operating environment. Additional venting improves airflow in all directions to keep the operator comfortable on hot and cold days alike.

Operator's Seat

The operator's seat is designed to reduce fatigue and maximize productivity. Standard air suspension, selectable heat and fully adjustable seat, back, arm rests and control consoles provide a truly custom fit for any operator.

* Pictured HW-A series cab.



COMFORT AND CONTROL

Improved Instrument Panel for Easier Monitoring

The HW-A series is designed with the operator in mind. A key feature of the new operator's cab in each HX series excavator is the convenient clustering of electronic controls and monitoring functions, resulting in improved operator accuracy and efficiency. The highly-advanced infotainment system, a product of Hyundai's comprehensive information technology capabilities, enables both productivity and comfort while working.

Intelligent and Wide Cluster

The 8-inch (203-mm) interactive touchscreen display is 15-percent larger than on previous models. The centralized switches on the display allow the operator to check the urea level and the temperature outside the cab. The audio AUX, air conditioner, heater integration, wiper, lamp, overload warning, travel and alarm functions also contribute to operator productivity. Also helpful is the inclinometer, which displays the machine level condition in real time for enhanced safety when lifting loads and improved accuracy when grading.



Innovative Haptic Control Module

Haptic control is a common technology found on luxury automobiles that makes selecting menus and adjusting settings easy. The haptic remote control uses vibrations and pulses to guide the operator through menu selections, enabling control of the accelerator, air conditioner, and all functions within the cluster for maximum convenience.

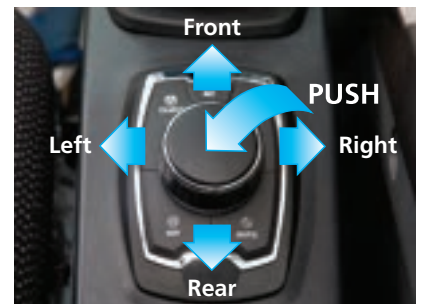

Smart Terminal Miracast System

The Smart Terminal – Miracast System uses the wi-fi from the operator's smart phone to easily and conveniently enable features of the smart phone, such as email, navigating, surfing the web, watching videos and selecting music, on the 8-inch (203-mm) screen. (Currently available for Android phones only.)



New Audio System

The audio system includes an AM/FM radio, a USB-based MP3 player, an integrated Bluetooth hands-free feature and a built-in microphone to allow for phone calls while at work and in transit. The audio system controls are located on the right side of the operator for convenient access.

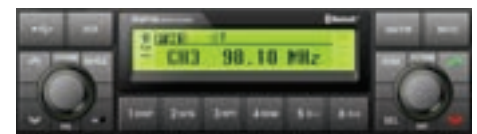

Heat and A/C in the Cab

Today's HX-A series crawler excavator cabs are equipped from the factory with integrated heating and air conditioning, providing a comfortable operating environment regardless of outside conditions.



* Features and options shown on this spread apply to the HW-A series.

ADVANCED TECHNOLOGIES AND SAFE SOLUTIONS



Ergonomics and Safety Lead the Way

Low noise, low vibration and ergonomic design are hallmarks of the new Hyundai HW-A series wheeled excavator design that combines advanced technology with maximum safety features. With an HW-A series wheeled excavator at work, your jobsite will be both safer and more productive.



▶ AAVM (All-Around View Monitoring) Camera System Option

The Hyundai-exclusive AAVM video camera system option maximizes operator awareness of the surrounding areas. This system allows a 360-degree field of vision for operators to help prevent accidents. Operators can maintain a constant view of the workplace to the front, the rear, the right and the left. AAVM provides a field of vision in all directions with nine views including a 3D bird's eye view and a 2D/4-channel view. The system includes IMOD (Intelligent Moving Object Detection) capability to alert the operator to the presence of people or objects within a specific range of operation (recognition distance: 5 m / 16 ft).



▶ Easy Access to DEF/AdBlue® Supply System

The DEF/AdBlue® tank is installed next to the tool box. Its inlet is remotely located for easy access and convenient supply. A red lamp signal warns of overfill. The DEF/AdBlue® supply module is attached on the side of the fuel tank for easy maintenance and filter replacement.



▶ Easy, Safe Entry and Exit

HW-A series excavator cabs offer safe, easy entry and exit, thanks to well-placed door handles, wide-opening doors and a sturdy grab bar next to the door.

* Features and options shown on this page apply to the HW-A series.

R55W-9A

FOR BIG POWER IN SMALL SPACES

The compact member of the Hyundai wheeled excavator family – the R55W-9A – brings big power to small spaces. You'll not only appreciate the durability and reliability of the R55W-9A, but also its ability to work productively in confined spaces. The R55W-9A boasts a range of standard features – including a large dozer blade, a quick-coupler for attachments, and auxiliary piping – that let you take on a variety of jobs. A standard pattern-change valve changes joystick control from SAE to ISO pattern, depending on operator preference. Serviceability enhancements include a wide-opening engine hood, centralized grease fittings and an easy-change plastic air cleaner.



› Comfortable Work Environment

The Hyundai R55W-9A features a spacious, ergonomically designed cab that delivers reduced noise and increased comfort and safety.



› Operator-friendly LCD Cluster

The R55W-9A includes an enhanced LCD cluster display that provides a variety of control and monitor functions.



› Boom-swing Function

The R55W-9A features a boom-swing function to improve productivity in confined workspaces.

Wheeled Excavator Family



BACKED BY HYUNDAI

Built to perform

HW-A series wheeled excavators, like all Hyundai equipment, are built to perform, day in and day out, to meet our customers' toughest expectations and quality standards.

North American dealer network

Hyundai construction equipment is sold and serviced through a growing network of more than 80 dealerships operating from nearly 200 locations across the United States and Canada.

Support

When you purchase a Hyundai machine you know your investment is as solid as the steel on our buckets and booms. You can count on the Hyundai difference.

- Products packed with value – with more standard features on every machine.
- Industry-leading standard warranty of 3-years or 3,000 hours, plus a 5-year, 10,000-hour structural warranty, with the option to add Hyundai Extend, an extended-warranty program.
- Knowledgeable, trained and experienced service personnel, backed by our solutions-focused field support team.
- Parts support, with an average 98-percent fill rate for parts orders submitted by our dealers on behalf of customers like you. Our warehouse in suburban Atlanta carries more than \$43 million in parts inventory.

